



Corona Ring OD-600x570

Home » Corona Ring Type » Corona Ring OD-600x570

Corona Ring OD-600x570

Download Product details

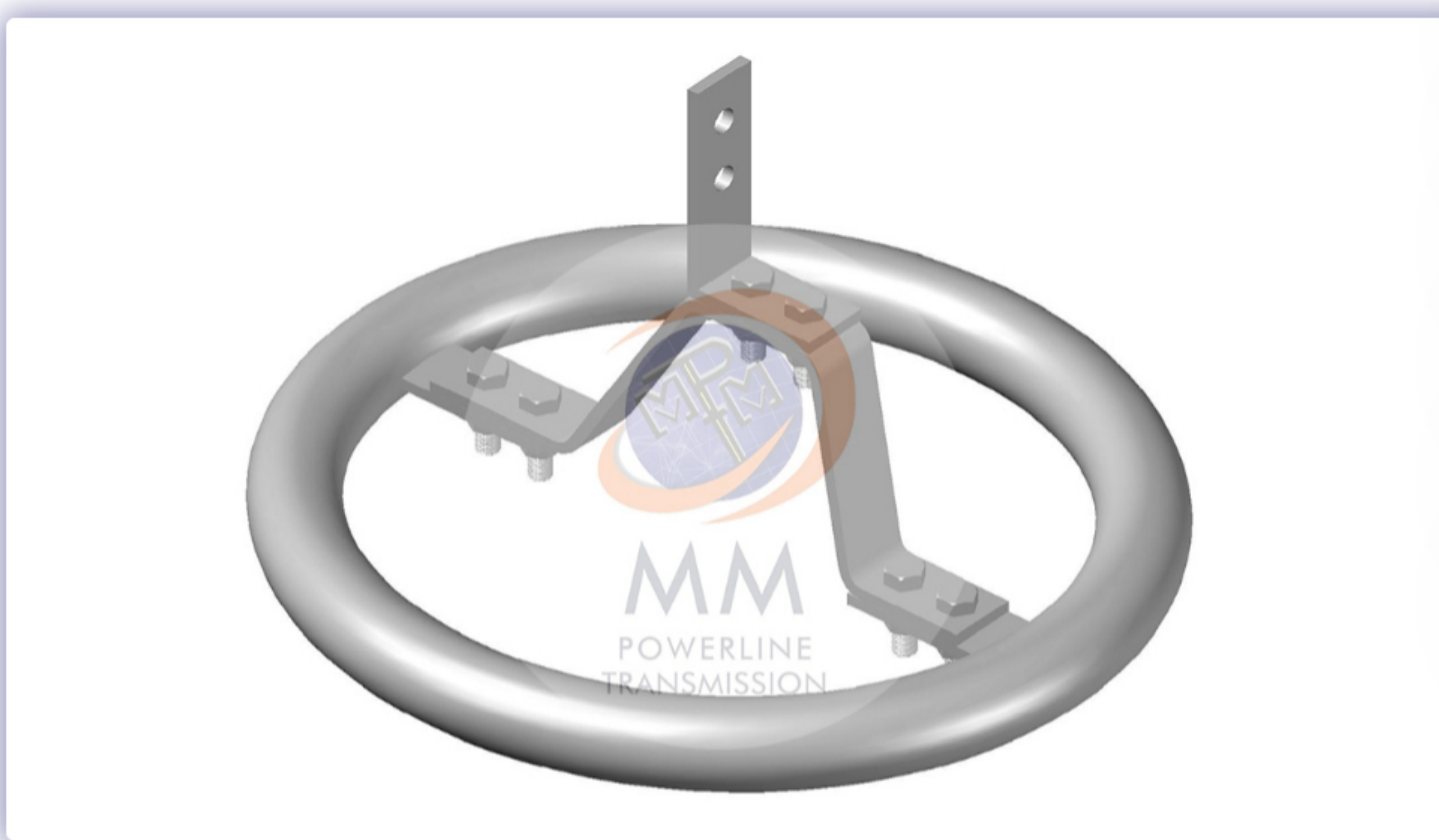

Other Product Quick Link

- TENSION FITTINGS-Compression Type
- TENSION FITTINGS-Bolted Type
- SUSPENSION FITTINGS AGS Type
- SUSPENSION FITTINGS-Envelope Type-With Armour Rod
- SUSPENSION FITTINGS-Envelope Type-Without Armour Rod
- SUSPENSION FITTINGS-Free Centre Type-With Armour Rod
- SUSPENSION FITTINGS-Free Centre Type-Without Armour Rod

At MM POWERLINE TRANSMISSION, we are dedicated to providing safe, reliable, and efficient power transmission systems. One crucial component that plays an essential role in achieving these goals is the Corona Ring (OD – 600 x 570). This important device is designed to prevent corona discharge, protect transmission components, and ensure the stability of power lines. In this article, we will explore the features, functions, and significance of the Corona Ring (OD – 600 x 570) in our transmission line infrastructure.

What is a Corona Ring (OD – 600 x 570)?

The Corona Ring (OD – 600 x 570) is a specially engineered component used in overhead power transmission lines to reduce corona discharge. Corona discharge occurs when the electric field around a conductor becomes strong enough to ionize the surrounding air, leading to energy loss and potential damage to transmission components. The Corona Ring (OD – 600 x 570) smooths out the electric field around the conductor, thereby preventing corona discharge and improving the performance and longevity of the transmission system.

With an outer diameter of 600mm and an inner diameter of 570mm, the Corona Ring (OD – 600 x 570) is designed for medium-voltage transmission lines, offering optimal protection and efficiency in a variety of power transmission setups.

Key Features

- Durable Construction:** The Corona Ring (OD – 600 x 570) is made from high-strength materials such as galvanized steel or stainless steel. These materials are corrosion-resistant and durable, ensuring long-lasting protection even under harsh environmental conditions.
- Efficient Design:** The ring's design helps evenly distribute the electric field around the conductor, minimizing electrical stress and preventing corona discharge. This ensures higher transmission efficiency and improved reliability.
- Precise Fit:** The Corona Ring (OD – 600 x 570) is designed to fit medium-voltage transmission lines perfectly, with an outer diameter of 600mm and an inner diameter of 570mm. This tailored fit maximizes the protective function of the ring, ensuring optimal performance.
- Ease of Installation:** The Corona Ring (OD – 600 x 570) is engineered for quick and easy installation. Its simple setup reduces the time required for installation and maintenance, ensuring minimal disruption to the power transmission system.

Functions of the Corona Ring (OD – 600 x 570)

- Preventing Corona Discharge:** The primary function of the Corona Ring (OD – 600 x 570) is to prevent corona discharge by redistributing the electric field around the conductor. This reduces the ionization of surrounding air, thus improving the overall efficiency of the power transmission system.
- Protecting Conductors and Insulators:** The Corona Ring (OD – 600 x 570) helps protect conductors and insulators by reducing electrical stress. By preventing corona-related damage, it extends the life of these vital components, minimizing the need for costly repairs or replacements.
- Improving Transmission Efficiency:** By mitigating corona discharge, the Corona Ring (OD – 600 x 570) enhances the efficiency of the transmission system. This leads to more effective power delivery with fewer losses, ensuring optimal performance.
- Increasing Safety:** The Corona Ring (OD – 600 x 570) helps reduce the risk of electrical faults, which could lead to accidents or equipment failure. Its protective function ensures the safe operation of power transmission systems, safeguarding both personnel and equipment.

Importance in Transmission Line Systems

The Corona Ring (OD – 600 x 570) is critical for the following reasons:

- Safety:** By preventing corona discharge and minimizing the risk of electrical faults, the Corona Ring (OD – 600 x 570) helps reduce the likelihood of accidents and equipment damage, contributing to the overall safety of the transmission system.
- Reliability:** The Corona Ring (OD – 600 x 570) enhances the reliability of power transmission by improving the efficiency of the system. It helps ensure the continuous and uninterrupted flow of power, contributing to the stability of the electrical grid.
- Cost Efficiency:** The Corona Ring (OD – 600 x 570) contributes to cost savings by extending the lifespan of critical transmission components such as insulators and conductors. This reduces the frequency of repairs and replacements, lowering overall operational and maintenance costs for MM POWERLINE TRANSMISSION.

Conclusion

The Corona Ring (OD – 600 x 570) is an essential component in MM POWERLINE TRANSMISSION's infrastructure, offering crucial protection and efficiency improvements. Its role in preventing corona discharge, protecting transmission components, and enhancing system performance is vital for the smooth operation of power transmission lines. As the demand for electricity continues to rise, ensuring the stability and reliability of the transmission network is more important than ever. The Corona Ring (OD – 600 x 570) plays a key role in achieving these goals, providing reliable protection and optimizing power transmission efficiency. Proper selection, installation, and maintenance of this component are vital for sustaining the integrity and performance of our transmission lines and meeting the growing energy needs of our communities.

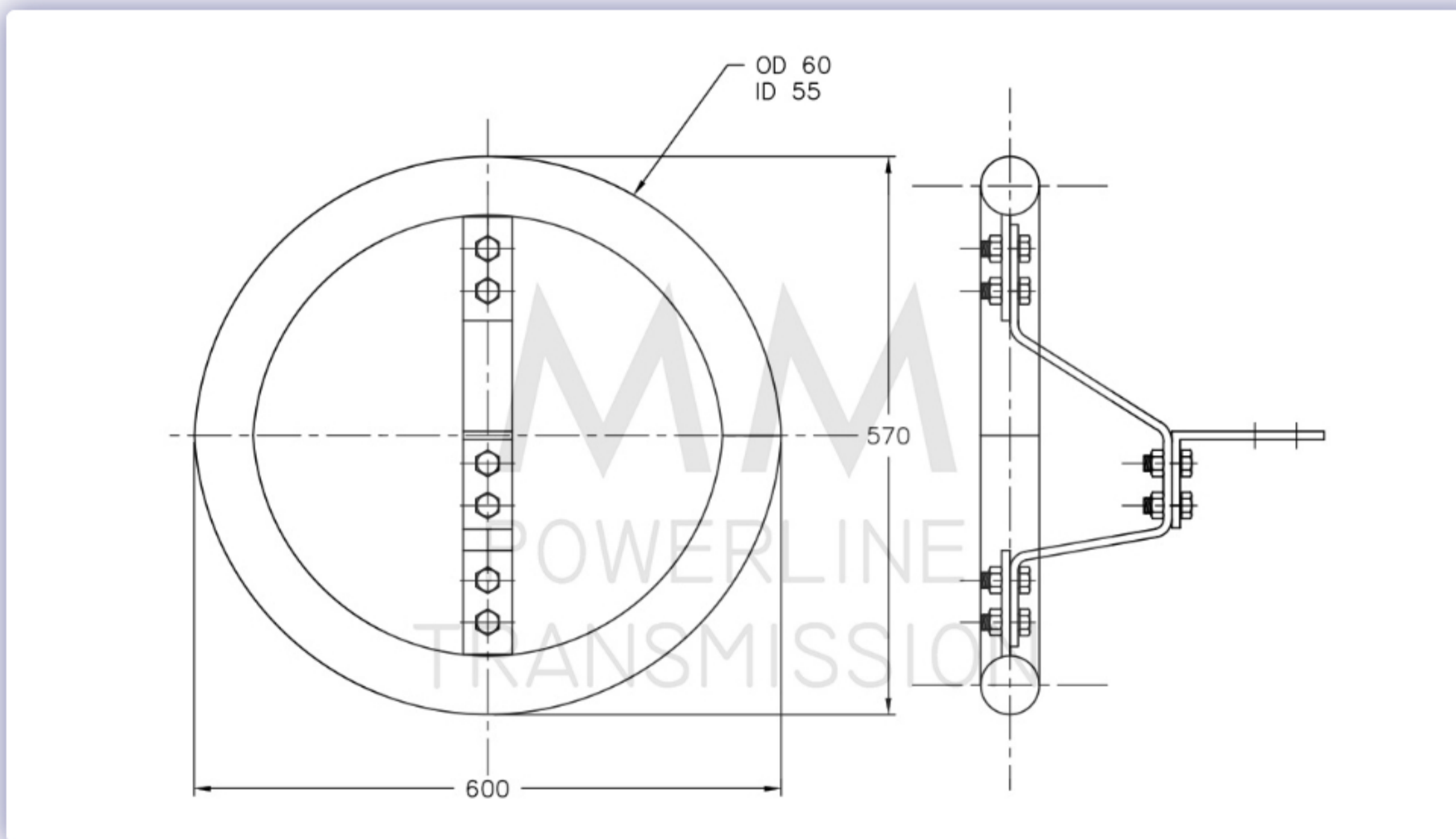

BOQ

SL. NO	DESCRIPTION	QTY	MATERIAL
1	CORONA RING	1 NOS	AL.ALLOY
2	BRACKET	1 NOS	AL.ALLOY/HDG STEEL
3	BOLT	6 NOS	HDG STEEL
4	NUT	6 NOS	HDG STEEL
5	ANGLE	1 NOS	HDG STEEL
6	FLAT	2 NOS	HDG STEEL

TECHNICAL DATA

- ALL DIMENSIONS ARE IN MM.
- GENERAL TOLERANCE ±5% UNLESS OTHERWISE SPECIFIED.
- FERROUS PART HOT DIP GALVANISED AS PER IS : 2633.
- CORONA RING & BRACKET AL. ALLOY

Our Brands



Contact Us

- Facebook
- Twitter
- LinkedIn

Quick Links

- Home
- About Us
- Career
- Contact Us

Address

Office : 2D,N.S.Road,shantinagar Colony,Compact Appt., Block-B,Flat-G001,Liluah,Howrah-711 204,West Bengal,India

Factory : 58,N.S.Road,Lilauh,Howrah – 711204,West Bengal,India

+91 8961536500
sales@mmpt.in

