

Socket Clevis

Download Product details



Other Product Quick Link

- TENSION FITTINGS-Compression Type
- TENSION FITTINGS-Bolted Type
- SUSPENSION FITTINGS AGS Type
- SUSPENSION FITTINGS-Envelope Type-With Armour Rod
- SUSPENSION FITTINGS-Envelope Type-Without Armour Rod
- SUSPENSION FITTINGS-Free Centre Type-With Armour Rod
- SUSPENSION FITTINGS-Free Centre Type-Without Armour Rod

At MM POWERLINE TRANSMISSION, we prioritize the reliability and safety of our power transmission systems. A critical component that contributes significantly to this goal is the socket clevis. This essential piece of hardware plays a vital role in securing conductors and ensuring the stability of our overhead power lines. In this article, we will explore the features, functions, and importance of the socket clevis in our transmission line infrastructure.

What is a Socket Clevis?

A socket clevis is a specialized connector used in overhead power transmission lines. It features a U-shaped design with a socket at one end, allowing for secure attachment to various components, including conductors and insulators. This design ensures a stable connection while facilitating easy adjustments and movements.

Key Features

- Durable Construction:** Socket clevises are crafted from high-strength materials such as galvanized steel or stainless steel, making them capable of withstanding harsh weather conditions and resisting corrosion.
- Robust Design:** The U-shaped design provides excellent load-bearing capacity, making the socket clevis suitable for a variety of applications within transmission line systems.
- Ease of Installation:** Socket clevises can be quickly and easily attached to different support structures, facilitating efficient setup and maintenance for our utility teams.
- Versatility:** These connectors are compatible with a wide range of conductor sizes and types, making them adaptable for diverse transmission line configurations.

Functions of the Socket Clevis

- Secure Connection:** The primary function of the socket clevis is to provide a stable and secure attachment point for conductors, ensuring they remain properly fastened under varying conditions.
- Load Distribution:** The robust design of the socket clevis helps evenly distribute loads across the transmission structure, minimizing the risk of localized stress and potential

failure.

- 3. Facilitating Movement:** The design of the socket clevis allows for flexibility, accommodating changes due to temperature fluctuations and wind without compromising structural integrity.
- 4. Enhancing Safety:** By ensuring secure connections, socket clevises significantly reduce the risk of electrical accidents, protecting both personnel and equipment.

Importance in Transmission Line Systems

The socket clevis is vital for several reasons:

- **Safety:** By providing secure connections for conductors, socket clevises help minimize the risk of electrical failures and accidents, safeguarding both personnel and equipment.
- **Reliability:** Consistent power delivery relies on robust transmission lines. High-quality components like socket clevises enhance the overall reliability of our systems.
- **Cost Efficiency:** By preventing wear and damage, and reducing maintenance needs, socket clevises contribute to lower operational costs for MM POWERLINE TRANSMISSION.

Conclusion

The socket clevis is an essential component of our transmission line hardware at MM POWERLINE TRANSMISSION. Its design and functionality are critical for ensuring the safety, reliability, and efficiency of our power delivery systems. As the demand for electricity continues to rise, maintaining a robust transmission infrastructure becomes increasingly important, underscoring the vital role of the socket clevis. Proper selection, installation, and maintenance of this component are essential for upholding the integrity of our transmission lines and meeting the electrical needs of our communities.

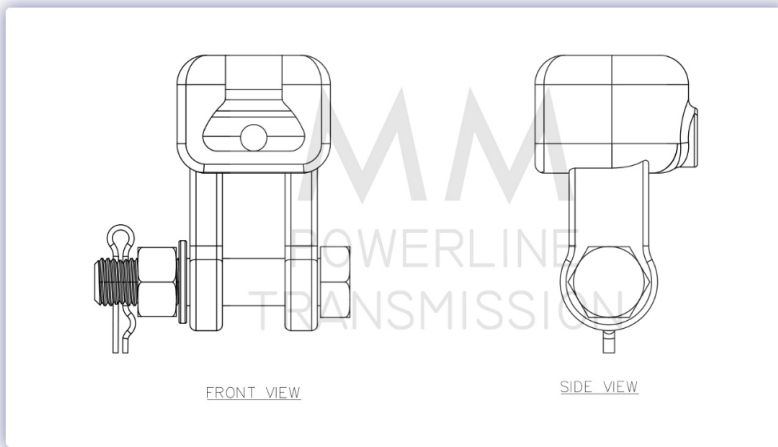

BOM

SL. NO	DESCRIPTION	QTY	MATERIAL
1	SOCKET CLEVIS	1 NOS	HDG STEEL, FORGED STEEL
2	R- CLIP	1 NOS	STAINLESS STEEL
3	HEX BOLT	1 NOS	HDG STEEL
4	HEX NUT	1 NOS	HDG STEEL
5	ROUND WASHER	1 NOS	HDG STEEL
6	SPLIT PIN	1 NOS	STAINLESS STEEL

TECHNICAL DATA

1. ALL DIMENSIONS ARE IN MM.
2. GENERAL TOLERANCE $\pm 5\%$ UNLESS OTHERWISE SPECIFIED.
3. HOT DIP GALVANISED AS PER IS : 2633.

Our Brands



Contact Us

- Facebook
- Twitter
- LinkedIn

Quick Links

- Home
- About Us
- Career
- Contact Us

Address

Office : 2D,N.S.Road,shantinagar Colony,Compact Appt., Block-B,Flat-G001,Liluah,Howrah-711 204,West Bengal,India

Factory : 58,N.S.Road,Lilauh,Howrah – 711204,West Bengal,India

+91 8961536500

sales@mmpt.in

